

# TEST GAUGE

The label *Trafag Industrial Components* extends the Trafag brand name to instruments manufactured by qualified partner companies. *Trafag Industrial Components* complement the genuine Trafag product range to offer customers a complete portfolio from one single source.

The TMP801 Test Gauge with high accuracy CL0.25 is designed for calibration and test applications.



## Applications

- Calibration & testing labs
- Calibration & testing of industrial pressure gauges

### Features

- Precision measuring system
- High resolution dial
- Knife Edge pointer
- Anti-parallax mirror band
- Jewel bearing movement
- Easy to read scale

### Reference

- EN 837-1

Standard parameters	
Accuracy	CL 0.25
Ambient temperature	20 ... +65°C
Service temperature	65°C max
Pressure limits	Steady pressure up to 75% of FS value
Weld joints	Silver alloy brazing
Measuring range	-1 ... 0 bar, -600 ... 0 mbar to 0 ... 700 bar

Ordering code		TMP801	- XX	- XXX	- XX	- XXX	- XX	- XX	- XX	- XXXX
1. Dial size	150 mm / 6"		06							
	250 mm / 10"		10							
2. Range	Refer "Range Table"			XXX						
3. Mounting pattern	Direct, Bottom connection				B0					
	Wall/Surface/Projection mounting, Bottom connection				B1					
	Lower, Back connection				L0					
	Panel/Front flange mounting, Lower Back connection				L1					
	Panel/Bracket mounting, Lower Back connection				L2					
4. Process connection <sup>1)</sup>	1/4" NPT (M)					12N				
	1/2" NPT (M)					14N				
	1/2" BSP (M)					14B				
	M20 X 1.5 mm (M)					14M				
5. Ingress protection	IP 65						ER			
6. Execution	Dry							EA		
7. Other options	Dampening screw, AISI 316 SS								EN	
	Cu-Alloy Shank								MA	
	AISI 316 SS shank								MF	
	SS tag plate, AISI 304 SS								XF	
	Custom designed dial								XR	
	Dial tag marking								XT	
8. Accessories	Gauge saver									A202
	Gauge snubber									A201

<sup>1)</sup> For other connections, please contact factory.

Specifications		
<b>Material of construction</b>	Sensing element	Bourdon Tube (<100 bar: C - type , >100 bar: Helical)
	Case & Ring material	AISI 304 SS (Bayonet type)
	Bourdon tube	Beryllium Copper
	Shank	Copper alloy
	Integral dampening screw	Copper alloy
	Movement mechanism	High precision (Jewel bearing type)
	Dial	Aluminum, green with black marking & anti-parallax mirror band
	Pointer	Balanced, knife-edge micrometer adjustable
	Pointer stopper	Spring type
	Gaskets & Blow off disc	NBR
	Window	Safety glass
<b>Standard specifications</b>	Dial size	DN150 / DN250
	Range	-1 ... 0 to 0 ... 700 bar
	Mounting pattern	Direct, Bottom connection
	Process connection	1/2" NPT (M) / 1/2" BSP (M)
	Ingress protection	IP 65
	Execution	Dry
	Carring case	Pine wood carrying case
	Calibration certificate	Calibration certificate traceable up to National & International standards
<b>Temperature effect</b>	When temperature of the measuring system deviates from reference temperature (+20°C) max error $\pm 0.4\%$ / 10K of true scale value.	

## Dimensions - All dimensions are in mm

Type B0

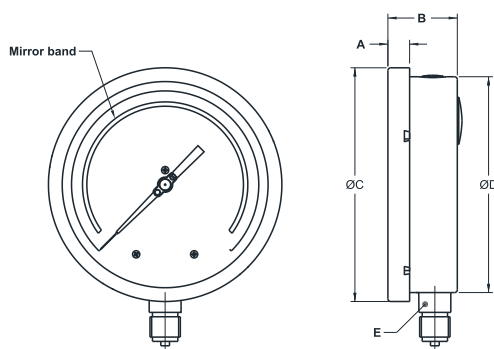

Type L0

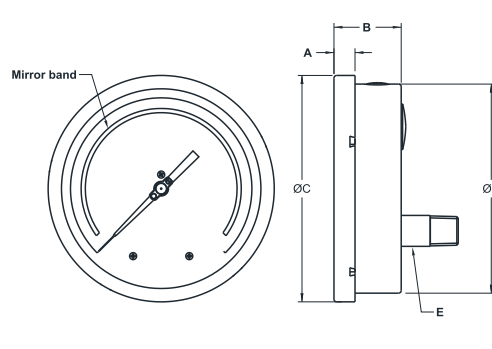

DN	A	B	ØC	ØD	E	Weight (grams)
150	15	48	161	149	SQ.22	950
250	18,5	50	263	250	SQ.22	2150

DN	A	B	ØC	ØD	E	Weight (grams)
150	15	48	161	149	SQ.22	950
250	18,5	50	263	250	SQ.22	2150

## Type B1

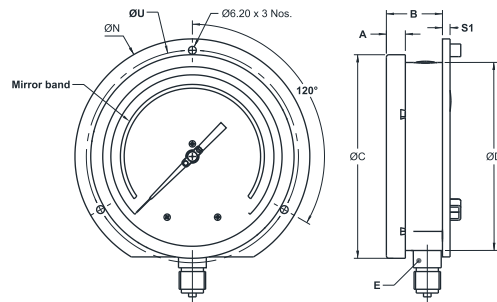

DN	A	B	ØC	ØD	E	ØI	M	ØN	S1	ØU	Weight (grams)
150	15	46	161	149	SQ.22	6	172,4	186	6	168	1065
250	18,5	48	263	250	SQ.22	7	286,5	290	1,5	276	2375

## Type L1

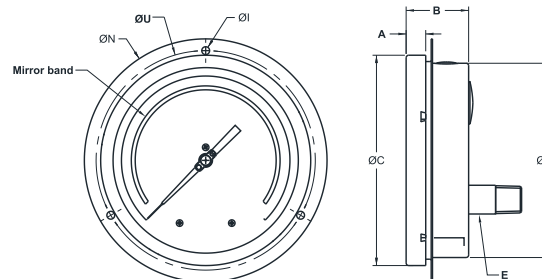

DN	A	B	ØC	ØD	E	ØI	ØN	ØU	Weight (grams)
150	15	48	161	149	SQ.22	6	186	168	1066
250	18,5	50	263	250	SQ.22	7	290	276	2350

## Type L2

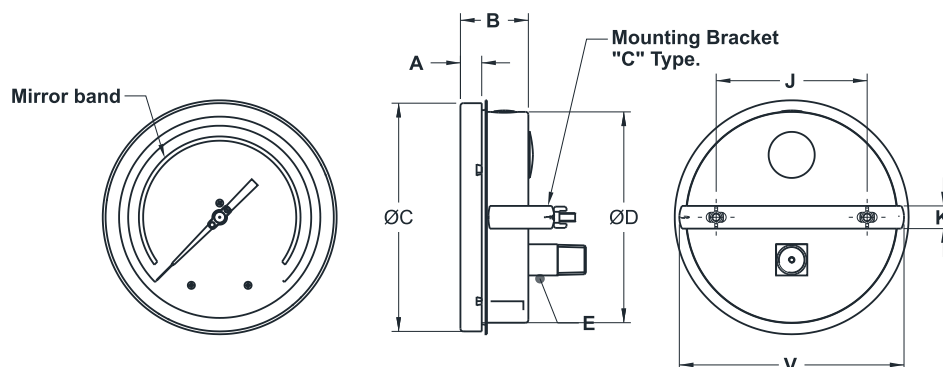

DN	A	B	ØC	ØD	E	J	K	V	Weight (grams)
150	15	48	161	149	SQ.22	106,5	16	158,5	1150
250	18,5	50	263	250	SQ.22	180	30	270	2450

Standard Ranges				Standard Ranges		Standard Ranges		Standard Ranges		Standard Ranges	
RANGE	bar	Kg/cm <sup>2</sup>	bar/psi	RANGE	psi	RANGE	kPa	RANGE	MPa	RANGE	mbar
0 ... 0.6	B01	K01	N01	0 ... 10	S01	0 ... 60	E01	-	-	-600 ... 0	B00
0 ... 1	B02	K02	N02	0 ... 15	S02	0 ... 100	E02	0 ... 0.1	M02	-	-
0 ... 1.6	B03	K03	N03	0 ... 25	S03	0 ... 160	E03	0 ... 0.16	M03	-	-
0 ... 2.5	B05	K05	N05	0 ... 35	S05	0 ... 250	E05	0 ... 0.25	M05	-	-
0 ... 4	B06	K06	N06	0 ... 60	S06	0 ... 600	E06	0 ... 0.4	M06	-	-
0 ... 6	B07	K07	N07	0 ... 90	S07	0 ... 600	E07	0 ... 0.6	M07	-	-
0 ... 7	B08	K08	N08	0 ... 100	S08	0 ... 700	E08	0 ... 0.7	M08	-	-
0 ... 10	B09	K09	N09	0 ... 150	S09	0 ... 1000	E09	0 ... 1	M09	-	-
0 ... 16	B11	K11	N11	0 ... 235	S11	0 ... 1600	E11	0 ... 1.6	M11	-	-
0 ... 25	B13	K13	N13	0 ... 365	S13	0 ... 2500	E13	0 ... 2.5	M13	-	-
0 ... 40	B16	K16	N16	0 ... 600	S16	0 ... 4000	E16	0 ... 4	M16	-	-
0 ... 60	B17	K17	N17	0 ... 870	S17	0 ... 6000	E17	0 ... 6	M17	-	-
0 ... 70	B18	K18	N18	0 ... 1000	S18	0 ... 7000	E18	0 ... 7	M18	-	-
0 ... 100	B19	K19	N19	0 ... 1500	S19	0 ... 10000	E19	0 ... 10	M19	-	-
0 ... 160	B21	K21	N21	0 ... 2300	S21	0 ... 16000	E21	0 ... 16	M21	-	-
0 ... 250	B24	K24	N24	0 ... 3600	S24	0 ... 25000	E24	0 ... 25	M24	-	-
0 ... 400	B27	K27	N27	0 ... 6000	S27	0 ... 40000	E27	0 ... 40	M27	-	-
0 ... 600	B29	K29	N29	0 ... 8700	S29	0 ... 60000	E29	0 ... 60	M29	-	-
0 ... 700	B30	K30	N30	0 ... 10000	S30	0 ... 70000	E30	0 ... 70	M30	-	-
-1 ... 0	B37	K37	N37	-30 ... 0 <sup>1</sup>	S37	-100 ... 0	E37	-0.1 ... 0	M37	-	-
-1 ... 0.6	B38	K38	N38	-30 ... 10 <sup>1</sup>	S38	-100 ... 60	E38	-0.1 ... 0.06	M38	-	-
-1 ... 1.5	B39	K39	N39	-30 ... 20 <sup>1</sup>	S39	-100 ... 150	E39	-0.1 ... 0.15	M39	-	-
-1 ... 3	B42	K42	N42	-30 ... 45 <sup>1</sup>	S42	-100 ... 300	E42	-0.1 ... 0.3	M42	-	-
-1 ... 5	B43	K43	N43	-30 ... 75 <sup>1</sup>	S42	-100 ... 500	E43	-0.1 ... 0.5	M43	-	-
-1 ... 9	B45	K45	N45	-30 ... 130 <sup>1</sup>	S45	-100 ... 900	E45	-0.1 ... 0.9	M45	-	-
-1...15	B47	K47	N47	-30 ... 220 <sup>1</sup>	S47	-100 ... 1500	E47	-0.1 ... 1.5	M47	-	-
-1...24	B49	K49	N49	-30 ... 350 <sup>1</sup>	S49	-100 ... 2400	E49	-0.1 ... 2.4	M49	-	-

#### General notes

- Other scales & measurement units are available.
- Equivalent scales available in kg/cm<sup>2</sup>, psi, kPa, MPa, bar/psi, kPa/bar, kPa/psi or any other special scales.
- Primary scales shall be in "BLACK" and secondary scales shall be "RED".
- Special scales, custom dial designs, OEM/private logo printing is available, details contact our marketing team.
- Any other range codes which are not available in the list shall be confirmed by factory.

#### Technical note

- In compound ranges, negative pressures are marked in In Hg, hence for example for -1 to 1 bar the corresponding scale shall be -30"Hg to 15 psi.

#### Additional information

Documents	Data sheet	H20011	<a href="http://www.trafag.com/H20011">www.trafag.com/H20011</a>
	Instructions	H21001	<a href="http://www.trafag.com/H21001">www.trafag.com/H21001</a>